



Commercial

Exceeding Expectations

Constant Communication

Minimum Disruption

# BPG Scores a Blinder With Glossop North End Community Club



## CASE STUDY

### SECTOR

Commercial

### CLIENT

Glossop North End

### DATE

37 Weeks - 2023

BPG was part of an incredible project to create a home for one of the most recognised leaders in grass roots football in the North West of England. This was a development of their entire infrastructure through a new Community Hub Club Room and state-of-the-art, floodlit 3G Football Turf Pitch (FTP). All achieved with £2.4million pounds of funding from the Premier League, the F.A, the Government backed Football Foundation, and community fundraising. Together, we were able to build an incredible sporting legacy for generations to come.

## Assisting Big Goals for an Incredible Club

Glossop North End is a registered charity and Charter Standard Community Club with full accreditation from the Derbyshire. F.A. and Nike Partner status. With over 600 boys and girls of all abilities representing the club in over 45 teams from 6 years old to 18, it provides an invaluable service for the community through football activity. The club had suffered from a lack of modern facilities for a long time and needed to create a home that was fit for purpose for its members and status. BPG was delighted to come onboard and make the plans a reality with our dedicated team and committed attitude.

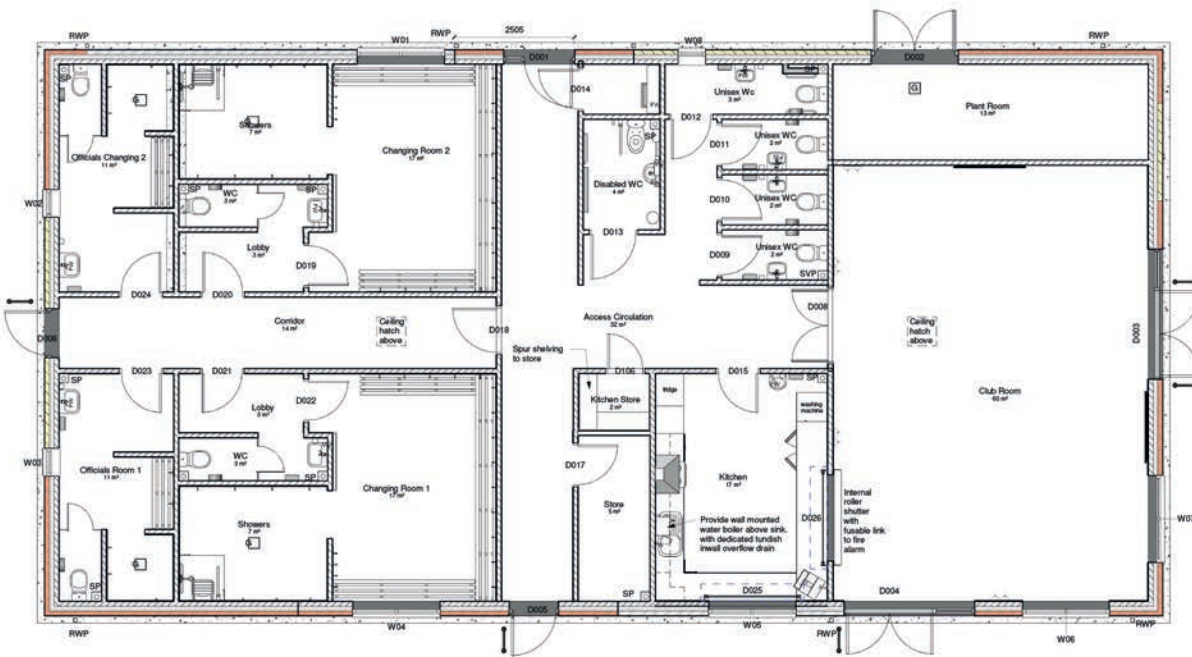

## Understanding The Challenge

Coordinating our work with the necessary incoming supply providers can often be particularly challenging. For this project, we needed to liaise with ENWL through open and constant communication to establish the correct specifications for the facility and keep all stakeholders informed on progress. Without 3phase supply to the area we also had to embark on a Wayleave agreement process with the adjacent landowners to the site that would ensure right of access as we installed and created a new electrical power infrastructure. These types of challenges demand that communication between all parties is continuous, professional and connected to share all of the information between us successfully. This was particularly important as we also experienced additional pressures through the great British weather and long lead times on vital resources.



## Engineering Value at Every Step

It was clear how much this project would mean to the members of the club and wider community. With the budget firmly fixed through the various funding sources we knew that value engineering would be essential to manage the exceptions and obstacles that jobs such as this inevitably uncover. BPG is always looking for ways to exceed expectations through all the work we undertake and for Glossop North End Community Club, we were delighted to keep bring this project in on budget with the minimum disruption to the surrounding area and landowners.



## Scope of Works

BPG was responsible for a full suite of services on this 37 week project that involved several integrations with sub-contractors, suppliers and resource providers. It began with the development and maintenance of Ecology Surveys on the site and soon became clear that access would be a primary concern. The perfect example of this was initially creating a successful diversion of a public footpath to accommodate the work. We could then safely remove the old club house and start to build their new home and modern facilities in a comprehensive way.

## A breakdown of the full works is detailed here:

- Site levels formed for car park & drainage
- Demolition of existing dilapidated club house
- New Surface and foul drainage system created
- Tricel Novo 18 drainage installed with petrol interceptor tank
- Foundations for club house laid
- Block and beam floor installed
- Masonry works completed thorough the internal and external facility space
- Formation of new access road into facility and closure of existing pathways
- Diversion of public footpath
- Ecology surveys carried out and maintained for the life of the project
- Roof works completed
- Concrete floors and screening works completed
- Internal Fit out for Club room to include:
  - Kitchen - WCs & Washrooms with toilet cubicles
  - Changing rooms with concealed shower fittings and hygienic cladding
- Plant room
- Tarmac footpath and parking bays created
- Mechanical and electrical works completed with air source heat pump installed
- Fixtures and fittings including concealed shower fitting with hygienic cladding
  - Toilet cubicles, coat hooks, benches
- Brand new electrical supply from ENWL specified, managed and installed
- 3G Football Turf Pitch laid



## Impact & Legacy

Learning about the long term effects that this project will have on the club was one of the greatest aspects of being involved for the BPG team. It gives them the impetus to build for the future and enhance so many more lives for young people through professional sport coaching. It also represents new and bigger income opportunities with the incredible facilities available to hire as a private space for the wider community. This was a win all round for everybody concerned and BPG was integral to making it happen through our dedicated work and management.

*"The Community Club now has its own home. Grassroots football and sport and physical activity more broadly, have significant benefits for all its participants, making them happier and healthier. With this new facility, the Club will deliver lifechanging and sustainable benefits for the area as well as having positive economic and social value."*

David Rowlinson. Chairman



## Let's Get Talking

Our Industrial High Care Environment Team of specialists are always ready to talk about your next project. Drop us a line here or give us a call and we can get started together.

 **Building Projects**  
For High Care Environments

Connect with us  LinkedIn

### Head Office:

6 Graphite Business Park, Graphite Way  
Hadfield, Glossop, Derbyshire, SK13 1QH

Tel: 01457 861 702

Email: [info@buildingprojectsgroup.com](mailto:info@buildingprojectsgroup.com)